

# COMMON CLINICAL DISEASES

Diabetic&Renal injury Markers , Thyroid function, Fertility  
Cardiac Markers, inflammation Markers, Tumor Markers

Screening

Diagnosis

Treatment

Monitoring

Product Class	Test Item	Specimen Volume	Reaction Time	Qualifications	Product Class	Test Item	Specimen Volume	Reaction Time	Qualifications
COVID-19	SARS-CoV-2 Antibody	10 µL	10 min	CE	Tumor Markers	AFP	75 µL	15 min	CE NMPA
	SARS-CoV-2 IgM	10 µL	10 min	CE		PSA	75 µL	15 min	CE NMPA
	SARS-CoV-2 IgM/IgG	10 µL	10 min	CE		CEA	75 µL	15 min	CE NMPA
				fPSA		75 µL	15 min	CE NMPA	
Cardiac Markers	NT-proBNP	75 µL	15 min	CE NMPA	Fertility	β-HCG	20 µL	15 min	CE NMPA
	BNP	75 µL	15 min	CE NMPA		LH	75 µL	15 min	CE NMPA
	cTn I	75 µL	15 min	CE NMPA		FSH	75 µL	15 min	CE NMPA
	Myo	75 µL	15 min	CE NMPA		Prog	75 µL	15 min	CE NMPA
	CK-MB	75 µL	15 min	CE NMPA		PRL	75 µL	15 min	CE NMPA
	H-FABP	75 µL	15 min	CE NMPA		E2	75 µL	15 min	CE NMPA
	3 in 1 (cTn I/Myo/CK-MB)	75 µL	15 min	CE NMPA		Testosterone	75 µL	15 min	CE NMPA
	2 in 1 (cTn I/NT-proBNP)	75 µL	15 min	CE NMPA	AMH	75 µL	15 min	CE NMPA	
	hsCRP	10 µL	3 min	CE NMPA	Diabetic & Renal Injury Markers	HbA1c	10 µL	5 min	CE NMPA
	TnT	100 µL for whole blood 75 µL for plasma/serum	15 min	NMPA		MAU	75 µL	3 min	CE NMPA
Lp-PLA2	75 µL	15 min	NMPA	CysC		10 µL	5 min	CE NMPA	
				NGAL		75 µL	15 min	CE NMPA	
Thyroid Function	T3	75 µL	15 min	CE NMPA	β2-MG	10 µL	10 min	CE NMPA	
	T4	75 µL	15 min	CE NMPA	Inflammation Markers	PCT	75 µL for whole blood 50 µL for plasma/serum	15 min	CE NMPA
	TSH	75 µL	15 min	CE NMPA		CRP (hsCRP+CRP)	8.5 µL for whole blood 5 µL for plasma/serum	3 min	CE NMPA
	ft3	75 µL	15 min	CE		2 in 1 (CRP+PCT)	75 µL	15 min	CE NMPA
	ft4	75 µL	15 min	CE		SAA	10 µL	15 min	CE NMPA
				IL-6		75 µL	15 min	NMPA	
Coagulation	D-Dimer	15 µL for whole blood 10 µL for plasma	5 min	CE NMPA	Craniocerebral Injury Markers	S100β	75 µL	15 min	NMPA
	one step D-Dimer	100 µL for whole blood 75 µL for plasma	15 min	CE NMPA	Others	Cortisol	75 µL	15 min	NMPA
Vitamin	Vitamin D	75 µL	15 min	CE NMPA					

Ongoing: Ferritin, FOB, H.Pylori antigen, Vit-B12, ST2

**Wondfo**<sup>®</sup>

Guangzhou Wondfo Biotech Co., Ltd.  
Add: No. 8 Lizhishan Road, Science City, Luogang District,  
510663, Guangzhou, P.R. China  
Tel: +86-20-3229 6083  
Fax: +86-20-3229 6063  
E-mail: [Finecare@wondfo.com.cn](mailto:Finecare@wondfo.com.cn)  
Websites: [en.wondfo.com.cn](http://en.wondfo.com.cn)



Rev. A2 Rel.: 2020.11.11

Wondfo reserves all rights. All contents of this brochure are copyrighted by Wondfo.

Wondfo<sup>®</sup>



Racing For Life

**Finecare**<sup>™</sup>

**FIA Meter II Plus SE (FS-114)**

Fluorescence Immunoassay Analyzer

CE NGSP ifcc

# Fluorescence Immunoassay Analyzer

## FS-114

- Dimension : 239 x 278 x 148mm
- Weight : 3.3kg

## Built-in Thermal Printer

- Real-time auto-printing
- Support for external printer

## Connectivity

- Wifi connection to LIS/HIS
- RS 232 and Ethernet port
- 4 USB ports

## ID Chip Port

- Automatically reading of batch number and calibration information in the ID chip

## Designed Sampler

- Specially-designed sampler for small volume of specimen

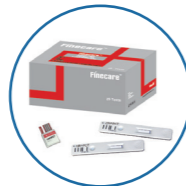

## Linux System

- Smooth operation
- Security system
- Custom intelligent management module
- Multi-user management

## Large Display

- 8" LCD Capacitive touch screen
- Intuitive user interface

## Portability

- 7800mAh battery
- Internal rechargeable battery
- 21-hours stand by time
- ≥200 tests without power supply

## Test Device Tray 40+

- Multiple testing modes available
- Unique quick mode for largenumber of samples

## Test Reagent

- Suitable for whole blood,serum, plasma and urin
- Room temperature storage
- Get results in 3-15 minutes

# Technical Advantages



## Portable

- Small size,
- 7800mAh built-in battery



## Convenient

- Easy to operate,
- large curved handle



## Instant Results

- Get results in 3-15 minutes



## Reliable Accuracy

- Good correlation with CLIA method



## Temperature Control

- Provide better reaction condition



# Operation Procedure

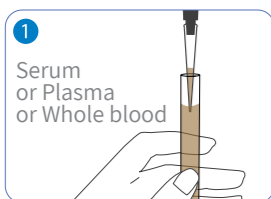

Sampling

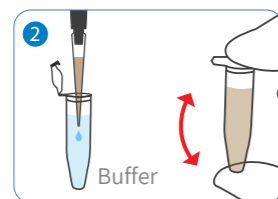

Mixing

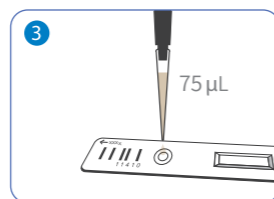

Dropping

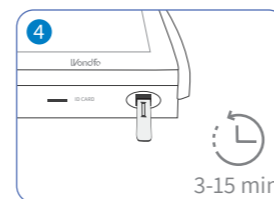

Reading

# Application



Laboratory



ER



Ambulance



Clinics



ICU



Clinical department